

THREERIVERSFESTIVAL
**RAFT
 RACE**

How to Build an 8' x 8' Raft

Materials:

- 2 sheets plywood – 4' x 8' x 5/8" chipboard
- 8 – 2" x 4" x 8' studs
- 1 – box 1 5/8" deck screws (approx. 150)
- 1 - box 3" deck screws (approx. 50)
- 2 – rolls of galvanized pipe strap (approx. 40')
- 1 – box of 3/16" flat washers (approx. 100)
- 4 – 55 gallon barrels

A. Build frame

1. Cut 5 – 2" x 4" x 8' studs to 93" (7' 9")
2. Assemble between 8' studs 2' on center
3. Use 2 - 3" deck screws per board

B. Attach plywood

1. Lay 2 sheets on top of frame
2. Square frame to plywood
3. Fasten with 1 5/8" deck screws 1' spacing
 (Note – around barrels 6" spacing with washers to resist upward force of barrel)

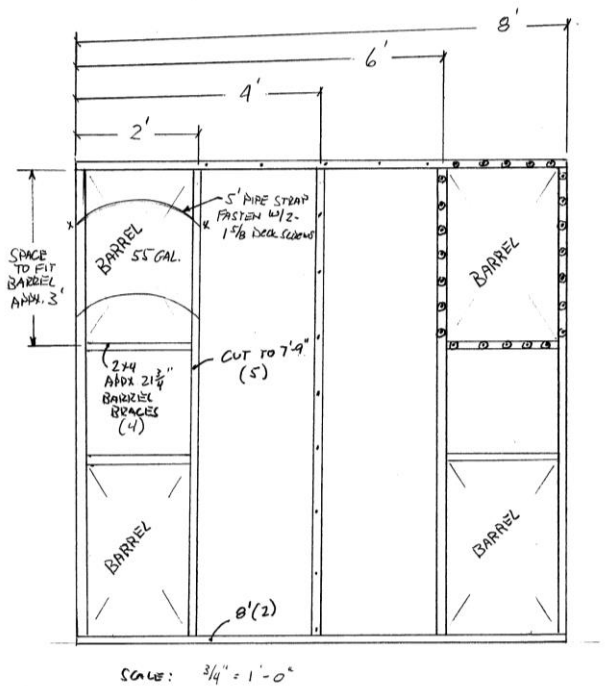

C. Attach barrels

1. Turn raft over
2. Position barrels at 4 corners
3. Cut 4 barrel braces approximately 21 3/4" attach at end of barrels
4. Attach 2 – 5' pipe straps over each barrel, fastening to frame

Need a bigger raft? Connect multiple 8' x 8' rafts together.

